

**211 Boom Arm**

21100.300.01 nickel

21100.300.02 chrome

21100.300.55 black

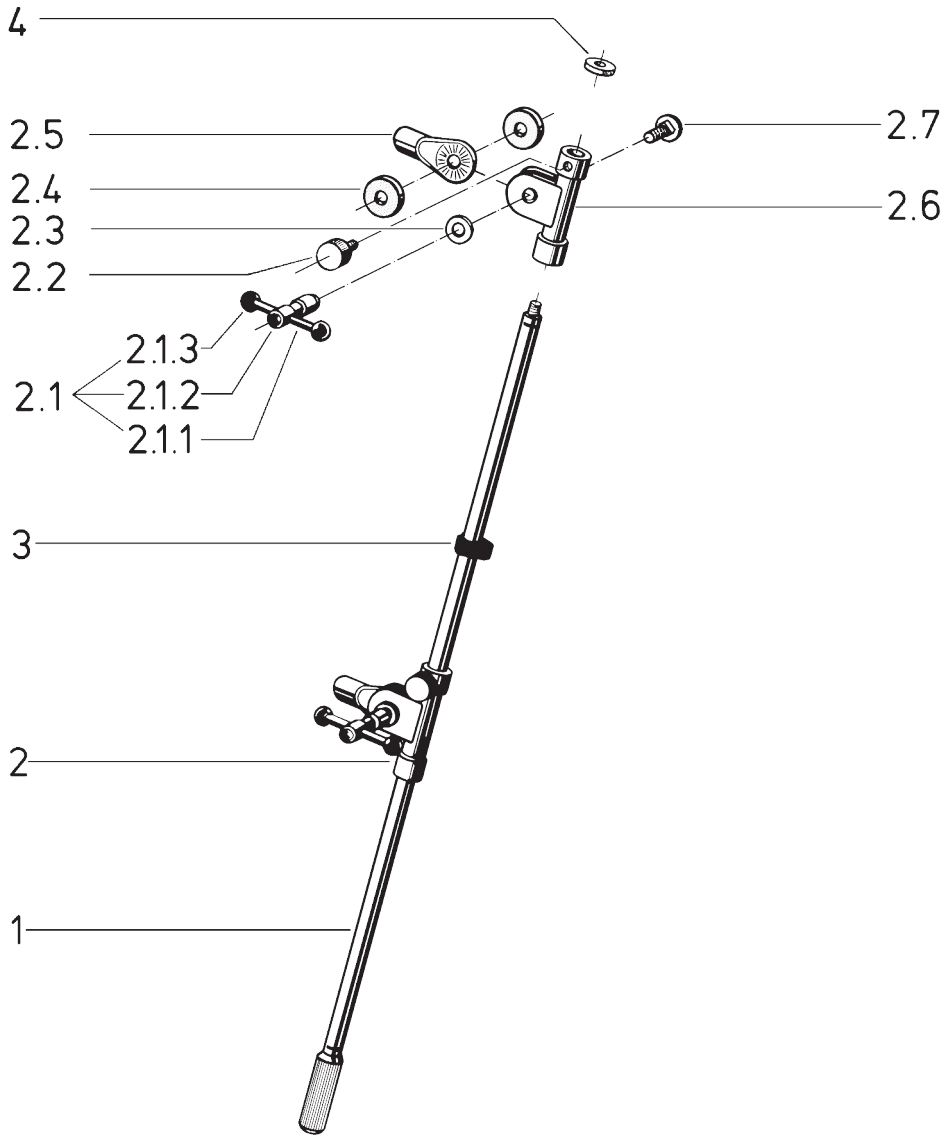

pos.	description	art.-no. nickel	art.-no. chrome	art.-no. black	qty
1	boom-arm with 3/8" thread	7.211.000101	7.211.000102	7.211.000155	1
2	swivel joint assembly, consisting of:	7.211.000301	7.211.000302	7.211.000355	1
2.1	T-bar screw assembly, consisting of:	6.30350.1.01	6.30350.1.02	6.30350.1.55	1
2.1.1	double sided M5 threaded rod	02.30.310.01	02.30.310.02	02.30.310.15	1
2.1.2	locking nut M8	02.30.350.01	02.30.350.02	02.30.350.15	1
2.1.3	plastic rod-end ball	03.22.510.55	03.22.510.55	03.22.510.55	2
2.2	knurled knob M6 x 12 mm	<a href="#">01.82.828.55</a>	<a href="#">01.82.828.55</a>	<a href="#">01.82.828.55</a>	1
2.3	steel washer	<a href="#">03.11.525.01</a>	<a href="#">03.11.525.01</a>	<a href="#">03.11.525.01</a>	1
2.4	rubber washer 3 mm thick	03.21.160.55	03.21.160.55	03.21.160.55	2
2.5	swivel head	<a href="#">02.40.430.55</a>	<a href="#">02.40.430.55</a>	<a href="#">02.40.430.55</a>	1
2.6	swivel joint	7.211.000255	7.211.000255	7.211.002155	1
2.7	carriage bolt	03.07.530.25	03.07.530.25	03.07.530.25	1
3	cable clamp	<a href="#">01.85.960.55</a>	<a href="#">01.85.960.55</a>	<a href="#">01.85.960.55</a>	1
4	aluminum washer	<a href="#">03.31.525.00</a>	<a href="#">03.31.525.00</a>	<a href="#">03.31.550.15</a>	1