

1. Slide collet nut, collet, washer, gasket and earthing cone on cable.
2. Strip cable to dimensions opposite.
3. Introduce conductor into contact and solder.
4. Solder the screen 'Z' over sleeve.
5. Fold screen 'ZZ' back over earthing cone.
6. Mount the two halves of the split insert carrier (note one half is keyed).
7. Push insert assembly into connector housing locating on key.
8. Screw collet nut on.

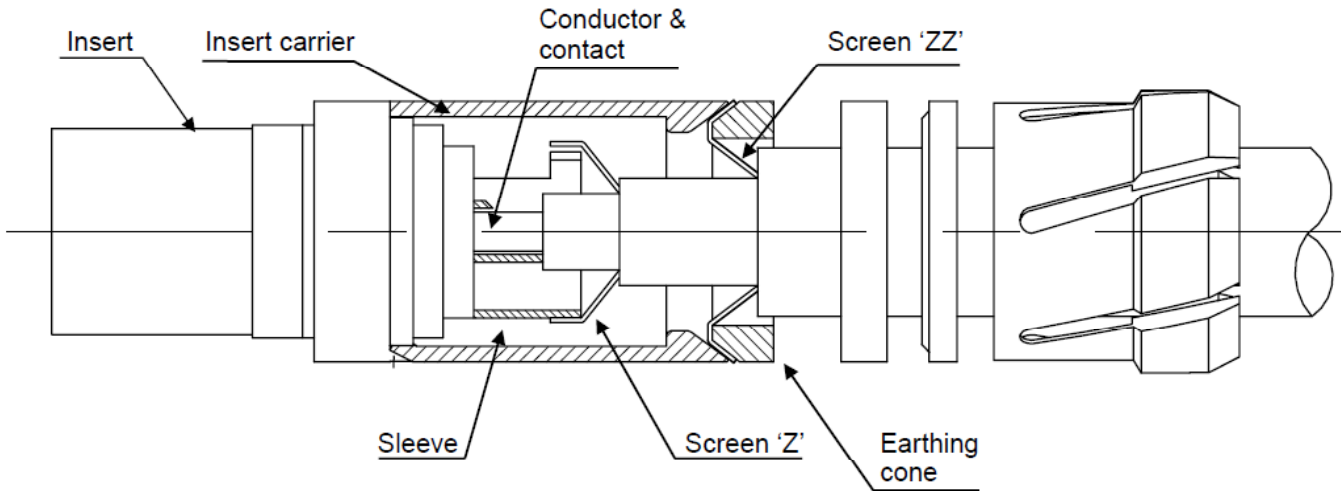

**FGG style**

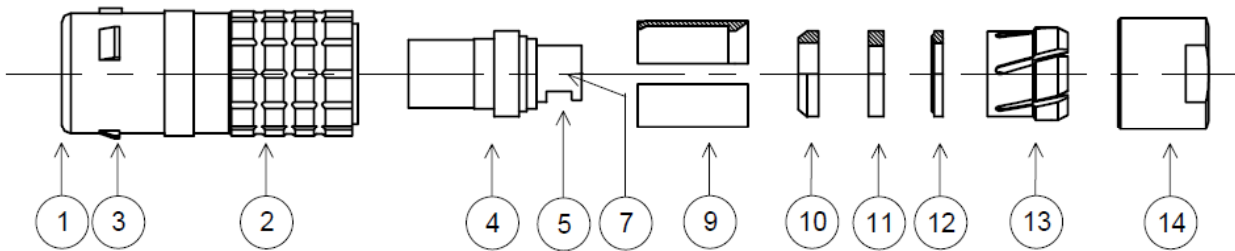

**PHG style**

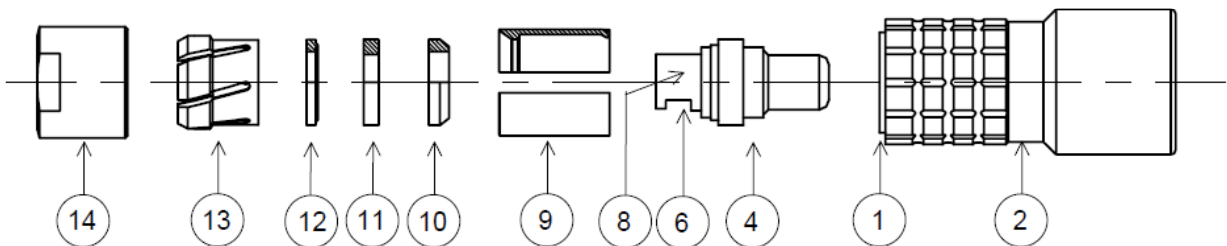

- |                  |                   |                         |                |
|------------------|-------------------|-------------------------|----------------|
| 1. Inner shell   | 5. Female sleeve  | 9. Split insert carrier | 13. Collet     |
| 2. Outer shell   | 6. Male sleeve    | 10. Earthing cone       | 14. Collet nut |
| 3. Spring sleeve | 7. Female contact | 11. Gasket              |                |
| 4. Insert        | 8. Male contact   | 12. Washer              |                |