



▶▶ NEUMANN.BERLIN

▶ NDH 30

OPEN DYNAMIC HEADPHONE

Quick Guide

Kurzanleitung
 Guide rapide
 Guida rapida
 Guía de inicio rápido
 Pikaohje
 Γρήγορος οδηγός
 Kısa Kılavuz
 Краткая инструкция

Guia rápido

Beknopte handleiding
 Krótka instrukcja obsługi
 Snabbguide
 Kort vejledning
 快速指南
 クイックガイド
 퀵 가이드

PUBL. 02/22 - 592814/A03

GEORG NEUMANN GMBH · LEIPZIGER STR. 112 · 10117 BERLIN · GERMANY
 TEL +49 (0)30 / 41 77 24 -0 · FAX -50
 HEADOFFICE@NEUMANN.COM · WWW.NEUMANN.COM



Quick guide

Safety guide

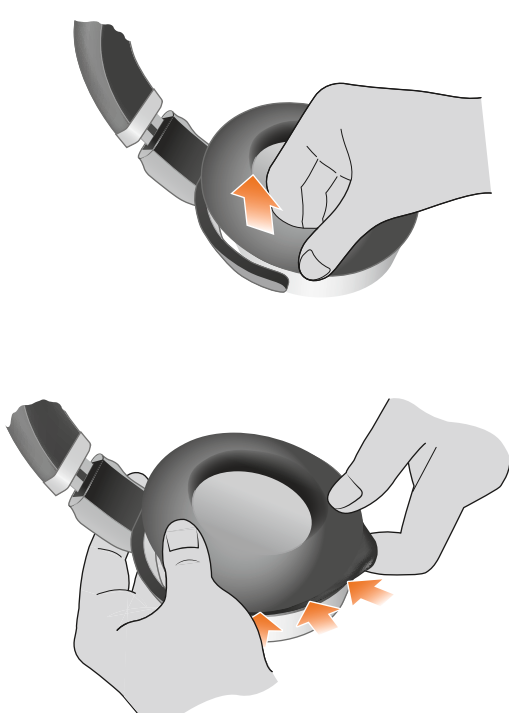
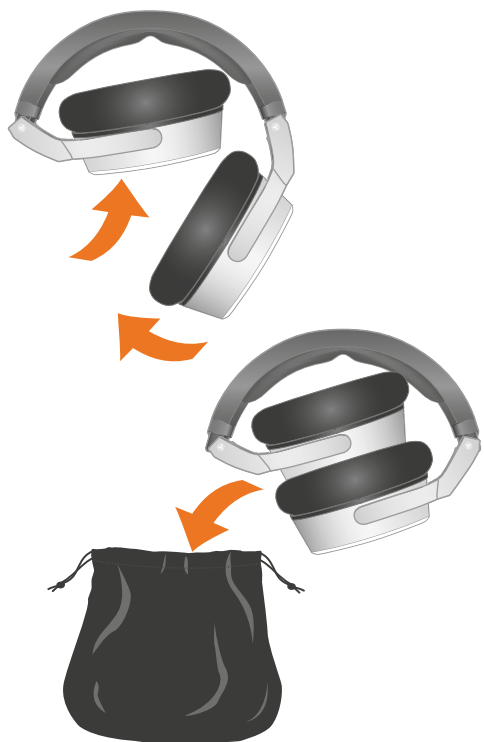

Specifications

Ear coupling	Circumaural
Acoustic principle	Open back
Transducer	38 mm dynamic driver with neodymium magnet
Impedance	120 Ω
Frequency range	12 Hz - 34 kHz [-3 dB]
Peak power handling	1000 mW
Continuous power handling	200 mW
Sound pressure level	104 dB SPL [1 kHz, 1 Vrms]
Total harmonic distortion (THD)	< 0.03 % [1 kHz, 100 dB SPL]
Magnetic field strength	4 mT
Weight	352 g (without cable)

Environmental conditions

Operating temperature	+5 °C to +45 °C (41 °F to 113 °F)
Storage temperature	-15 °C to +70 °C (5 °F to 158 °F)
Relative humidity	≤ 90 %